



**REGAL REALTY**  
CAYMAN

Queens Court, Seven Mile Beach, Grand Cayman, Cayman Islands  
+1 (345) 916-7080  
info@regalrealtycayman.com  
www.regalrealtycayman

## STONE'S THROW LITTLE CAYMAN

Little Cayman West, Little Cayman, Cayman Islands

MLS# 418686

**CI\$65,000**

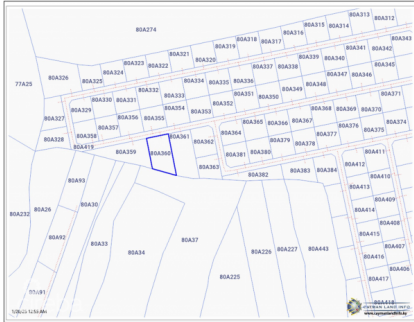



**Sandra Simmons-Francis**  
sandra@regalrealty.ky

Your Slice of Paradise Awaits on Little Cayman! Imagine owning a piece of untouched paradise in one of the most serene corners of the Caribbean. Nestled within the planned residential development of Stone’s Throw, this .3692-acre parcel of land offers the perfect balance of seclusion and convenience. With a protected parcel next door, your privacy is ensured, giving you the rare opportunity to build your dream home in tranquility. Why Little Cayman?Known for its pristine natural beauty, Little Cayman is a haven for those seeking peace and adventure. The island is home to some of the world’s best diving and snorkeling spots, including the legendary Bloody Bay Wall, teeming with vibrant marine life. Whether it’s basking on secluded white-sand beaches, exploring lush landscapes, or watching the sunset paint the sky in hues of gold, Little Cayman is an island like no other. Located in the exclusive Stone’s Throw development. Adjacent to a protected parcel, guaranteeing no development and ultimate privacy. Just minutes from Blossom Village, the heart of Little Cayman. Conveniently located near the airport, making your private retreat easy to access. This is your opportunity to escape the hustle and bustle and immerse yourself in the tranquility and beauty of Little Cayman. Whether you're building your dream island home or holding onto a slice of paradise for the future, this property is an investment in peace, privacy, and unparalleled natural splendor. Photos courtesy of Cayman Land Info

Essential Information

Type	Status	MLS	Listing Type
Land (For Sale)	Current	418686	Low density residential

Key Details

Width	Depth	Block & Parcel	Old Price
100	185	80A,360	0.00
Acreage			
0.3692			

Additional Fields

Block	Parcel	Views	Zoning
80A	360	Garden View	High Density Residential
Road Frontage	Soil		
100	Marl		